



GMM  
STONE MACHINERY

英特

ULTRA 6000

GMM  
STONE MACHINERY

CNC 5-AXIS SAWING MACHINE

数控五轴桥切机

[gmm.it](http://gmm.it)

# INTRAA 英特 600

## CNC 5-AXIS SAWING MACHINE

EN

The Intra blends the ease of use of a traditional manual machine, with the high output operator free sawing cycles. Simple and intuitive programming enables owners and operators to get the most from the machine - featuring parametric drawings, Cuts From CAD, Contouring, Bas relief, profiling and shaping, drilling and lettering, the machine can also be equipped (upon request) with the side spindle, a digital camera to provide a jpeg of the slab on screen, automatic shifting of sawn pieces saving time, man power, and raw material by using integrated Vacuum head, auto tool changing.

## 数控五轴桥切机

CN

英特(Intra)能像传统机器那样简易操作，并融合了现代数控简易、直观、高效、智能化的结合。具有参数化绘图让操作员更加简易、直观的编程。具有CAD导入切割、3D雕刻、轮廓与仿形、钻孔和刻字功能。可选配横向主轴、摄像头拍照功能实时大板照片采集，实时避开大板的暗裂、真空吸盘可自动移动板材/卸载，为工厂节省时间、人力和原材料、自动更换刀具(可选配)。



# 主要特点 Main Features

EN

- 370° rotating head, 90° tilting head
- Blade up to 725 mm (28.5 inches) diameter driven by frequency converter
- Vertical stroke (Z axis) of 600 mm (20.5 inch)
- Standard machine rails (Y axis) 2480 mm
- The main structures of the machine are in hot galvanized steel
- Automatic lubrication
- Sliding Safety barriers with polycarbonate panels with high visibility
- High speed, maximum precision thanks to brushless motors with absolute encoders, recirculating ball guides, precision gearboxes and interpolation of the axes with CNC
- 6000 rpm electrospindle with shaft drilled for water passage
- New Ergonomic Panel 21" multitouch LED color display with integrated machine controls, programming and control unit, USB port, LAN connection and remote service system

CN

- 工作头可任意370°旋转及90°倾斜
- 最大锯片安装直径725毫米(28.5吋)，由变频驱动
- Z轴最大行程: 600毫米(20.5吋)
- Y轴(标准)最大行程: 2480毫米
- 机器的主要结构为经过热镀锌处理的钢材
- 自动润滑功能
- 滑动折叠保护屏障，采用高能见度的聚碳酸酯面板
- 极高精度且高速的运作，有赖于CNC数控智能对带有绝对编码器的无刷电机、循环球轴承和精密齿轮箱等各个部件进行完美的联动操控
- 主轴转速为6000rpm，可配置中央出水
- 最新符合人体工学操作面板，配备21英寸多点触控LED彩色显示屏，带有集成机器控制、编排程序和控制装置、USB端、LAN网络连接和远程服务系统

## OPTIONS 选项

- Vacuum system with 3 sections
- Four position magnetic tool changer for auto changing core bits and router tools
- Side Aggregate Spindle 4 kw
- Polish tool (Ø 320 mm) n° 3 abrasives 36x2 with patented fast coupling Frankfurt
- Hydraulic tilting table driven by cylinder with dedicated power unit, structure in hot-dip galvanized steel with PVC table top

- 真空吸盘具有3个工作区域
- 4位磁力刀具库，自动更换钻头或铣刀工具
- 功率4KW的横向主轴
- 由n°3磨料36×2组成的抛光工具，並配有专利的法兰克福快速接头。
- 液压翻板台由液压缸驱动，配备转用液压动力装置，热镀锌钢结构，PVC台面

Standard 标配:

**NEW 21" TOUCH SCREEN HMI**  
全新 21 英寸人机界面触控屏



**CNC**  
TECHNOLOGY  
智能数控



**CAD**  
CAM  
CAD 绘图



**TELE**  
SERVICE  
远程维护



**READY**  
INDUSTRY 4.0  
工业 4.0



**TOUCH**  
SCREEN  
触摸彩屏

MAXIMUM STANDARD BLADE Ø / BLADE HOLE Ø 最大锯片直径 / 锯片中心孔直径	725 / 60 [mm毫米]
MAXIMUM LONGITUDINAL BLADE STROKE (X AXIS) / BRIDGE TRANSLATION (Y AXIS) 最大纵向切割行程 (X轴) / 最大桥身横移行程 (Y轴)	X AXIS 轴 3600 [mm毫米] / Y AXIS 轴 2480 [mm毫米] (variable on request 应要求可变)
MAXIMUM VERTICAL TRAVEL OF THE BLADE (Z AXIS) 最大垂直行程 (Z轴)	600 [mm毫米]
BLADE LOCKING FLANGE DIAMETER / MAXIMUM CUTTING DEPTH 锯片固定法兰直径 / 最大切割深度	213 / 205 [mm毫米]
MAXIMUM BLADE ORIENTATION ANGLE (W AXIS) 最大旋转角度 (W轴)	0 - 370 [°]
DIMENSION OF TILTING TABLE (0 - 85°) 翻板台尺寸 (0 - 85°)	2000 x 3500 [mm毫米]
MAXIMUM TABLE CAPACITY 最大台面承载量	3000 [kg公斤]
POWER OF BLADE MOTOR (*OPTIONAL) 锯片马达功率 (*选项)	16.5 (S6) [kW千瓦] / *23 (S6) [kW千瓦]
VARIABLE BLADE SPEED 锯片转速	800 - 6000 [rpm]
VARIABLE SLEDGE CUTTING SPEED (X AXIS) AND BRIDGE TRANSLATION SPEED (Y AXIS) 工作头滑切速度(X轴)及桥移速度(Y轴)	35 [m米/min分钟]
MAXIMUM SPEED Z AXIS 最大垂直移动速度 (Z轴)	7.5 [m米/min分钟]
COOLING WATER CONSUMPTION AT 3 BAR 冷却水耗量3巴时	40 [l升/min分钟]
AIR CONSUMPTION AT 6 BAR (* WITH SUCTION SYSTEM) 气压耗量6巴时(*带吸盘)	55 (*355) [l升/min分钟]
TOTAL MACHINE MASS 设备总重	3500 [kg公斤]
VOLUME WHEN PACKAGED OF THE MACHINE IN STANDARD VERSION 标配机器装运规格	20' O.T. container 开顶柜
STANDARD INSTALLATION DIMENSIONS (WIDTH X DEPTH X HEIGHT) 标准安装尺寸 (宽x深x高)	7890 x 4310 h.3760 [mm毫米]
STANDARD VOLTAGE/ FREQUENCY 标准电压/频率	400/50~3 [V伏特/Hz赫兹]
MINIMUM AIR PRESSURE 最低气压	6 [bar巴]
SIDE AGGREGATE SPINDLE 横向主轴	4 [kW千瓦] 12000 [rpm]
MAX TILTING CAPACITY 最大翻板承载量	1500 [kg公斤]

Available INTRA XL version with tilting table size (0 - 85°) of 2000 x 4000 [mm] / 另有 INTRA XL 版本, 翻板台尺寸 (0-85°) 为 2000x4000 [毫米]



**X AXIS 轴**

3600 mm 毫米



**Y AXIS 轴**

2480 mm 毫米  
variable 可变

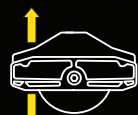

**Z AXIS 轴**

600 mm 毫米



**R AXIS 轴**

0 - 90°



**W AXIS 轴**

0 - 370°

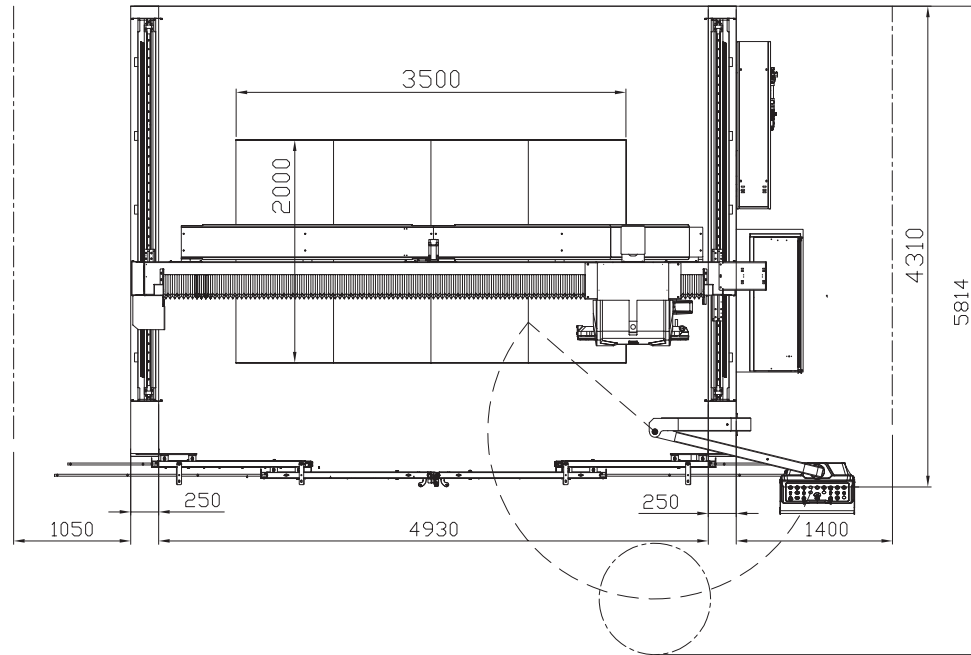
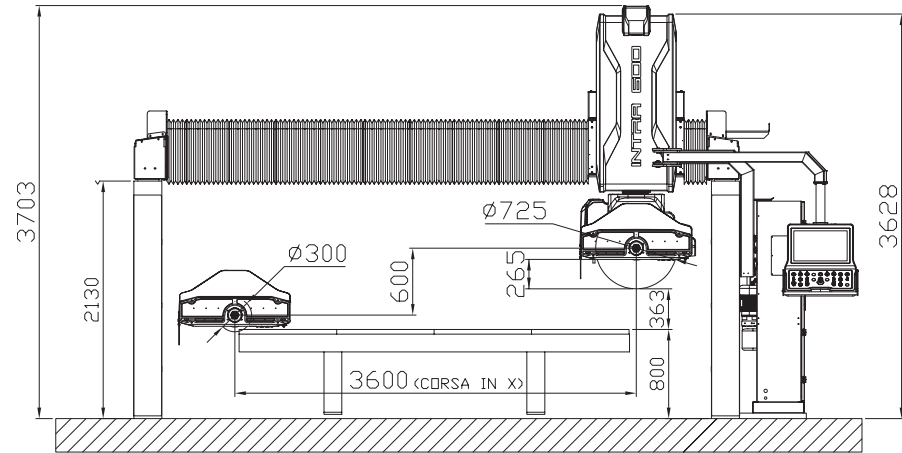

**SIDE SPINDLE**

— optional 选项 —

**横向主轴**

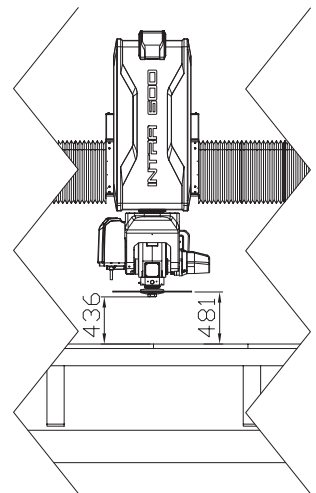

# UPGRADE YOUR INTRA 600 升级您的英特 600

## OPTIONS 选项

CODE 编号: A1477

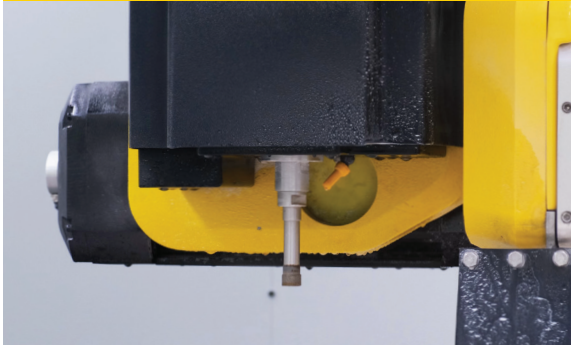

**SIDE AGGREGATE SPINDLE**  
横向主轴

CODE 编号: A1718



**FOUR POSITION MAGNETIC TOOL CHANGER FOR AUTO  
CHANGING CORE BITS AND ROUTER TOOLS**  
4位磁力刀具库，用于自动更换钻头或铣刀工具

CODE 编号: A5501

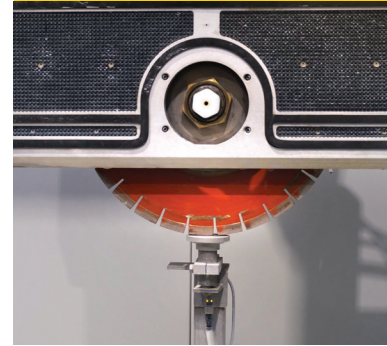

**TOOL DIAMETER  
CONTROL**  
刀具直径/长度测量器

CODE 编号: A5504



**SLAB THICKNESS  
READER**  
大板厚度检测仪

CODE 编号: A2646



**VACUUM SYSTEM WITH 3 SECTIONS  
DISC CASING OF Ø 625 mm**  
吸盘的三个区域置于锯片罩表面，  
可装Ø625的锯片。

CODE 编号: A5453



**CAMERA**  
摄像头

CODE 编号: A7254



**POLISH TOOL Ø 320 mm  
3 SEGMENT 36x2 FRANKFURT TEXTURE PLATE**  
由n°3磨料36×2组成的抛光工具，并配有专利的  
法兰克福快速接头。

CODE 编号: A6423

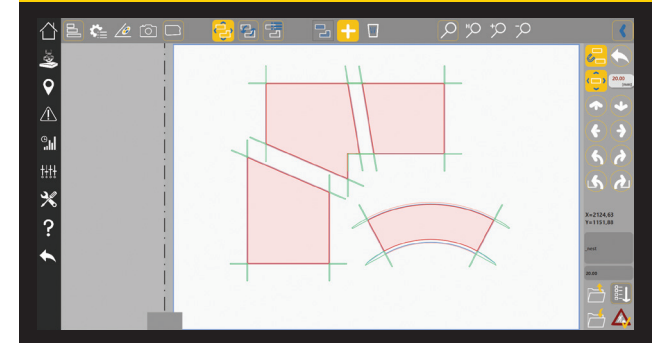

**OPTICAL DETECTOR  
TEMPLATE COPIER**  
光学模板探测器



CODE 编号: A6495

SPV VEINMATCH  
SPV 对纹加工

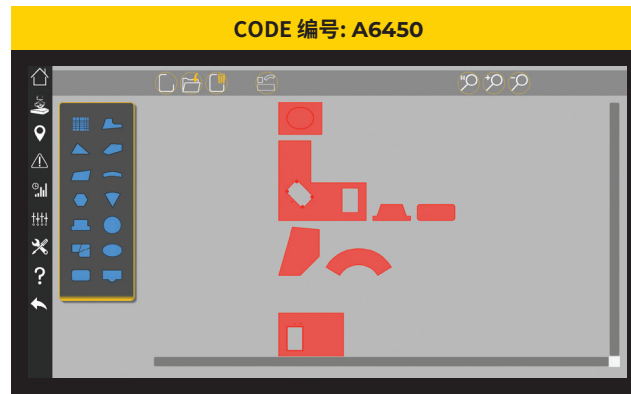

CODE 编号: A6450

PARAMETRIC PROGRAM  
参数化设计程序



CODE 编号: A6457

PROGRAM COMBINED CUTS FROM CAD  
CAD组合切割程序

# STANDARD MACHINE PROGRAM

## 机械标准程序



SINGLE CUT, MULTIPLE CUTS, INCLINED OR MITRE CUTS  
单次切，多次切，倾斜切



CIRCUMFERENCES, ARCHS  
切圆，弧线

INTRAF 600

# GMM

STONE MACHINERY



Full machines range  
& processing lines  
for stone shop.

专为石材加工而设的  
全系列机器



## 🇮🇹 ITALY

### GMM S.P.A.

HEADQUARTER Gravellona Toce (VB)

### GMM S.P.A. SCHIO

BUSINESS UNIT

### MECTOCE S.R.L.

PRODUCTION UNIT

### BAVELLONI S.P.A.

HEAD OFFICE / PRODUCTION UNIT

### BAVELLONI S.P.A.

TOOLS DIVISION / PRODUCTION UNIT

## 🇺🇸 U.S.A.

### GMM USA INC.

COMMERCIAL / AFTER SALES UNIT

### BAVELLONI AMERICA INC.

COMMERCIAL / AFTER-SALES UNIT

### TECHNI WATERJET LLC

COMMERCIAL / AFTER SALES UNIT

## 🇫🇷 FRANCE

### BAVELLONI FRANCE

DISTRIBUTOR

## 🇩🇪 GERMANY

### GMM STEINBEARBEITUN GMBH

DISTRIBUTOR / AFTER SALES UNIT

### WPA WATERJET PRODUCTION ACADEMY GMBH

DISTRIBUTOR

## 🇦🇺 AUSTRALIA

### TECHNI WATERJET LTD.

MELBOURNE HEAD OFFICE

## 🇹🇭 THAILAND

### TECHNI WATERJET LTD.

PRODUCTION UNIT

## 🇧🇷 BRAZIL

### BAVELLONI DO BRASIL COMÉRCIO DE MÁQUINAS LTDA

COMMERCIAL / AFTER-SALES UNIT

## 🇲🇽 MEXICO

### Z.BAVELLONI MEXICO S .A. DE C.V.

COMMERCIAL / AFTER-SALES UNIT

## 🇭🇰 HONG KONG

### GMM INTERNATIONAL LTD.

COMMERCIAL / AFTER SALES UNIT

凌意国际有限公司

## 🇨🇳 CHINA

### GMM QUANZHOU LTD.

COMMERCIAL / AFTER SALES UNIT

泉州意美美机械有限公司

[gmm.it](http://gmm.it) / +39 0323 849711 / [gmm@gmm.it](mailto:gmm@gmm.it)

**IMPORTANT:** machines displayed in the present catalogue are without safety barriers in order to ensure the perfect vision of all the details of the machine. All machines will be delivered and installed with safety barriers as per current legislation. The data in the present catalogue may vary without notice due to continuous update of technology.

重要说明: 本说明书为了更清晰地展现设备全貌, 在拍照时撤离了安全保护屏障, 设备在实际交付与安装时都会配备安装保护屏。本产品说明书中的所有参数可能因更新原因而有所不同, 请按照当时咨询时为准。

